

# AGILA2PH

MOTORCYCLE LIFT FOR VEHICLE INSPECTION,  
**CATEGORY OF VEHICLES : L1, L3**

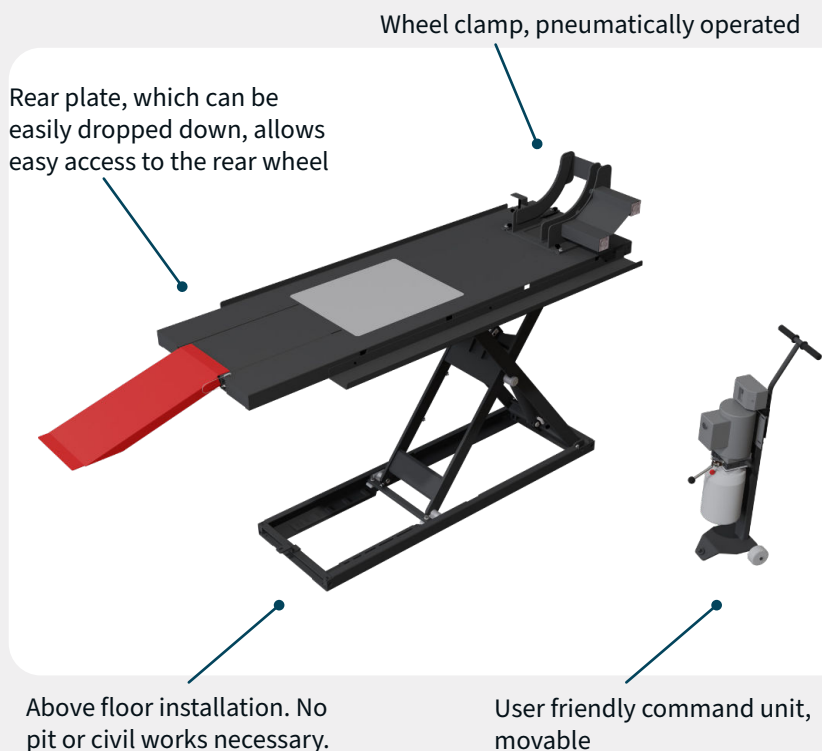

Ultimate lifting solution to cover any requirement in vehicle inspection (European category L).

This lift features an electro-hydraulic drive system, with power pack located in the mobile command unit, providing smooth, silent, and quick working operations (raising time : 30 seconds).

The space saving configuration allows perfect access all around the lift to the vehicle, with the possibility for the inspector to stand very near to raised vehicle. This specification is ideal for vehicle inspection activities.



SPECIFICATIONS	AGILA2PH
Lifting capacity	1000 kg
Drive	Electrohydraulic
Min. height	160 mm
Max. lifting height	1200 mm
Lifting platform length	2200 mm
Lifting platform width	700 mm
Lifting / lowering time	30 sec. / 30 sec.
Air supply	6-8 bars
Power supply / E-motor power	230V / 1ph / 50 Hz / 2,2kW
Net weight	335 kg
Conformity to standard	CE

## DIMENSIONS (IN MM)

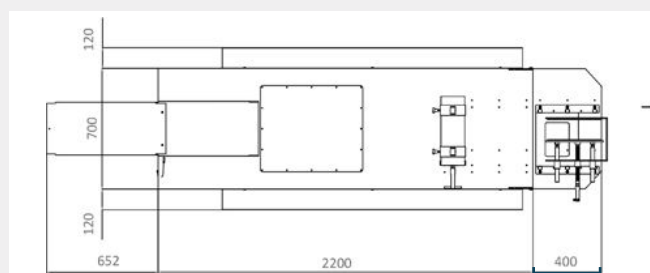
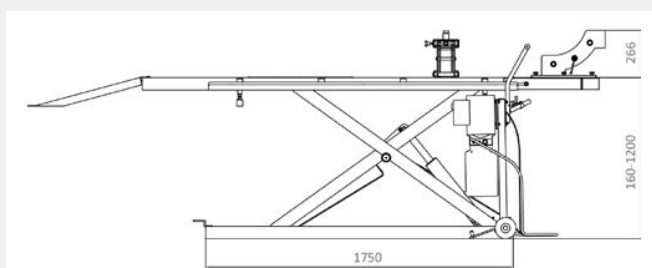

Option : front platform extension

- Electro-hydraulic drive system, with power pump unit located in the command unit, providing smooth, silent and quick operations. A mechanical safety latching device, with locking positions every 10 cm, automatically sets in safe position once the movement stops. Air supplied unlocking device will automatically operate once the lift gets lowered.
- The AGILA2PH provides perfect access all around the vehicle in raised position. Lateral platform extensions, primarily designed for foot protection, are also useful as tool trays.
- The area for the crutch is mechanically reinforced & fitted with an anti-skid additional plate, ensuring better durability and a better ease of use.
- Lateral sides of the platform, can receive safety strap hooks, to clamp the motorcycle to the lift platform for safety reasons. Receptacles for safety strap, located at regular intervals, allows convenient and quick installation of safety straps (safety straps are optional).



**INCLUDED ACCESSORIES**

Pneumatic front wheel clamp



Tool trays, lateral sides

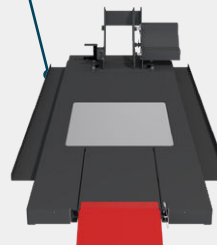

STANDARD EQUIPMENT	AGILA2PH
Electro-hydraulic drive with power unit in the command unit	standard
1x lifting platform with scissor lifting device	standard
1 drive-in/out ramp, which becomes automatic safety wheel stopper once the lift has raised	standard
Power unit can be positioned at a max. Distance of 1 meter from the lift	standard
Removable wheel clamp, pneumatically operated, with safety anti-release system.	standard
OPTIONAL ACCESSORIES	REFERENCES
Jacking beam 500 kg	TRAV1M
Lifting platform front extension (+400 mm), tiltable	KITEXT2PH

**PACKAGING**

Parcel Nr. 1 - 231 kg

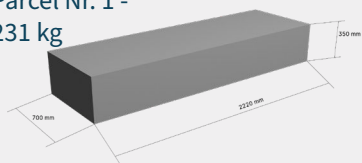

Parcel Nr. 2 - 40 kg

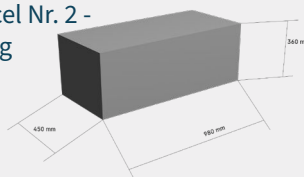

Parcel Nr. 3 - 21 kg

