

Catalogue

WORKSHOP LIFT EQUIPMENT

- 2 POSTS LIFTS
- 4 POST LIFTS
- WHEEL FREE SCISSORS LIFTS
- BIG SCISSORS LIFTS
- JACKING BEAM
- LIFTING TABLE



2-POST LIFTS



AZUR RANGE

2-POST ELECTRO-HYDRAULIC LIFTS

Our new range of 2-post lifts comprises lifts with base on the floor, and lift baseless overhead gantry type.

2-POST LIFT WITH BASE ON THE FLOOR

Our range of 2-post lift with base AZURXXCH, consists in three models with different lifting capacities to cover all the possible configurations found in the workshops, with no boundaries regarding available roof height, and for a wide variety of vehicles :

- Ref. AZUR35CH : 3.5 t
- Ref. AZUR42CH : 4.2 t
- Ref. AZUR50CH : 5.0 t

Those lifts can accommodate vehicles with lower ground clearance, thanks to their low lifting pad height.

2-POST LIFT OVERHEAD GANTRY LIFT

We offer our 2-post lift baseless AZUR42CH with a capacity of 4,2 t, providing a totally flat ground under the vehicle. This lift is particularly well adapted to electric vehicles (special accessories for this purpose to be chosen among a wide range of accessories).

- Ref. AZUR42AH : 4.2 t



SPECIFICATIONS	AZUR35CH	AZUR42CH	AZUR50CH	AZUR42AH
Base type / baseless type	base type	base type	base type	baseless type
Main lift capacity	3.5 t	4.2 t	5.0 t	4.2 t
Net weight	630 kg	660 kg	997 kg	730 kg
Max. lifting height	1900 mm	1900 mm	1900 mm	1990 mm
Min. pad height	90 mm	90 mm	100 mm	90 mm
Lifting / lowering time	45/55 sec.	45/55 sec.	55/60 sec.	55/55 sec.
Overall height	2825 mm	2825 mm	2912 mm	3900 mm
Distance between columns	3420 mm	3420 mm	4028 mm	2830 mm
Concrete slab min. thickness	200 mm	200 mm	200 mm	200 mm
Base plate for concrete slab thickness 130 mm	option	option	-	-
Front arms with 2 sliding parts, min./max length	615-1150 mm	615-1150 mm	-	615-1150 mm
Rear arms with 1 sliding part, min./max. length	890-1390 mm	890-1390 mm	-	890-1390 mm
Front & rear arms (symmetrical), min./max length	-	-	900-1800 mm	
Power supply	400 V / 3 ph / 50 Hz / 16 A / 2.2 kW			

RELIABILITY

- All components are tested at the factory. Easy and straightforward installation procedure. Low maintenance requirements.

TECHNOLOGY

- Full electric, ergonomic controls with push buttons.
- Accurate positioning system (APS) for precise lift height adjustment, without raising before lowering.
- Electric upper limit switch.
- No air supply

SAFETY

- Latching device with mechanical locking position every 10 cm, electrically and automatically activated.
- Levelling done by the mean of very reliable mechanical ropes, preventing any difference of level between the carriage units.

PERFORMANCES

- CHASS 130 : optional reinforced full base frame for AZUR35CH and AZUR42CH, for installation on weak floor, with concrete only 130 mm thick.
- Front lifting arms short with 2 extension sliding parts, allowing an easy and safe raising of small vehicles on asymmetrical lifts (AZUR35CH, AZUR42CH and AZUR42AH).
- Heavy duty symmetrical lift AZUR50CH with 4 extra-long extensible arms, for a wide variety of commercial vehicles, small trucks and motor-home vehicles.



DIMENSIONS AZUR35CH

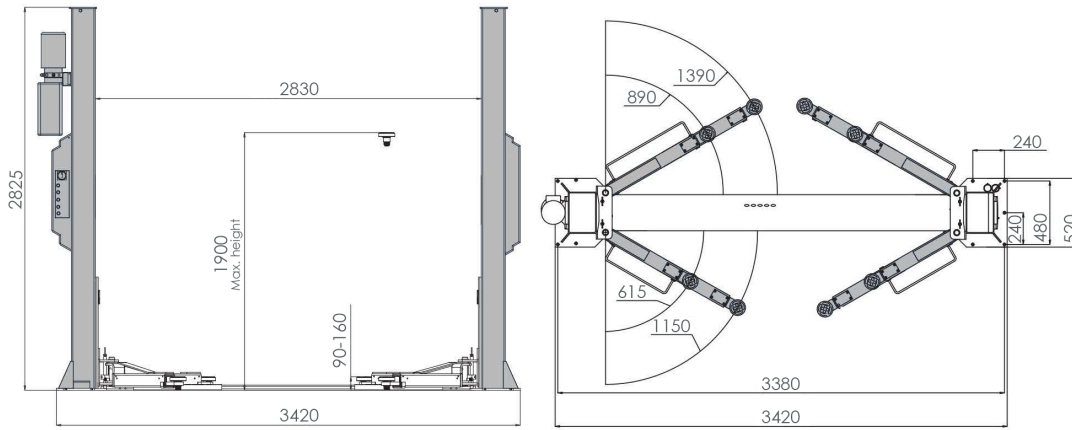

DIMENSIONS AZUR42CH

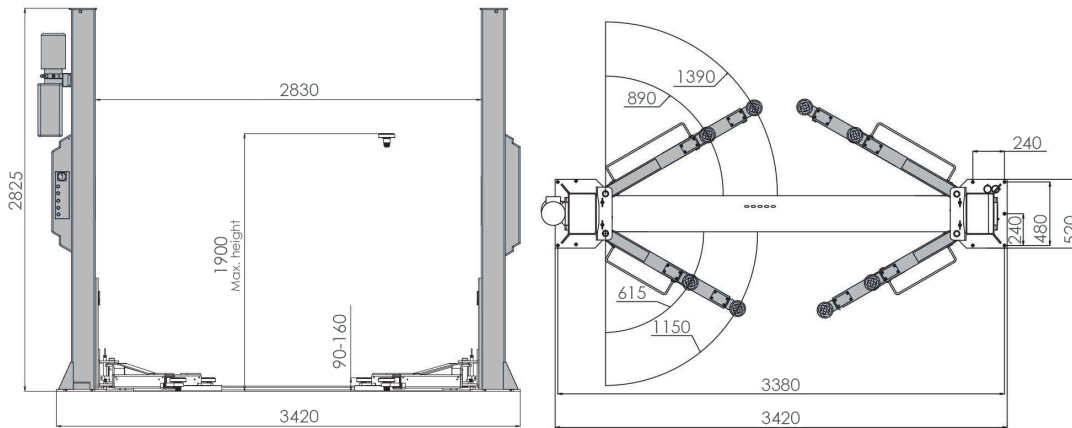

DIMENSIONS AZUR50CH

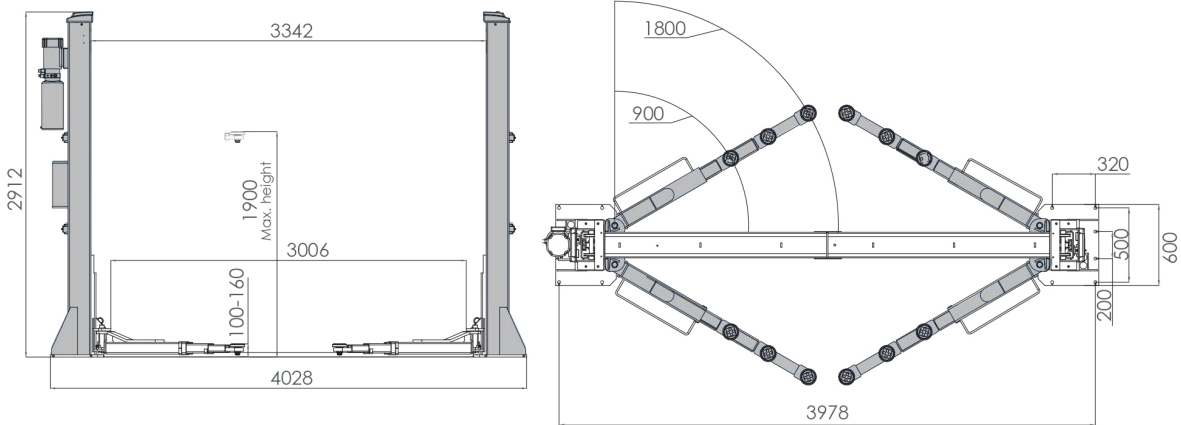

DIMENSIONS AZUR42AH

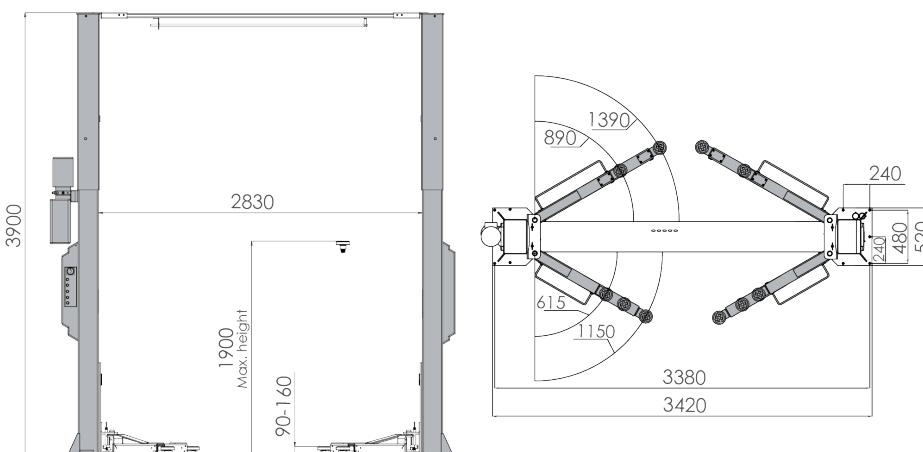

ACCESSORIES FOR 2-POST LIFTS

	AZUR35CH	AZUR42CH	AZUR50CH	AZUR42AH
	EV.612005002	EV.612005002	EV.612035001	EV.612005002
	EV.612004209	EV.612004209	EV.612013009	EV.612004209
	EV.791210002	EV.791210002	EV.791210041	EV.791210002
	EV.791110027	EV.791110027	EV.791210013	EV.791110027
	EV.791110028	EV.791110028	EV.791210034	EV.791110028
	EV.791110009	EV.791110009	EV.791210033	EV.791110009
	EV.791210025	EV.791210025	EV.791110031	EV.791210025
	4948521	4948521	-	-
	CHASS130	CHASS130	-	-
	-	-	-	EV.791210009
	-	-	-	KITBAR42AH

SPECIAL ACCESSORIES FOR ELECTRIC VEHICLES

Ref. KITVE42AH

Kit for servicing electric vehicles. Compatible with lift AZUR42AH. This kit allows vehicles to be raised under their wheels. Thus, no part of the lifting arms will be located in the vicinity of the vehicle underbody, providing the perfect clearance under the vehicle battery that is necessary to remove or service it.

Comprising:

- 4 rotating lifting forks to replace the original lifting pads (capacity/wheel : 875 kg)
- 2 lifting arms « long » (890-1390 mm).



4-POST LIFTS



QUADRA RANGE

HIGH PRECISION 4-POST LIFTS

Our 4-post lifts combine workmanship quality with a perfect design and advanced technology.

4-POST LIFTS ALIGNMENT LIFTS WITH INTEGRATED AUXILIARY LIFT

- Ref. QUADRA548LA : 5 t / platform length 4880 mm
- Ref. QUADRA552LA : 5 t / platform length 5280 mm
- Ref. QUADRA558LA : 5 t / platform length 5780 mm

4-POST LIFT WITH FLAT TRACKS

- Reference QUADRA552CP : 5 t / platform length 5280 mm

An optional jacking beam can be installed on all our models of 4-post lifts.

Advanced technologies and sophisticated specifications give our 4-post lift the ability to accommodate virtually all kinds of light vehicles and most commercial vehicles and vans.

All of our lifts are CE certified and conform to the standards in Force in the E.U.

RELIABILITY

- All components are tested at the factory. Easy and straightforward installation procedure. Low maintenance requirements.

QUALITY

- High quality paint with sealer applied at metal joints.
- Power pack, cross-beam pulleys and column upper plates, are covered by finishing and sound insulating hoods.
- Cable routing between main columns and platform is done in a special articulated plastic drag chain. No cable and no oil tube remains visible, ensuring long lasting duty and good looking finish.

SAFETY

- Full electro-hydraulic functions
- Safety latching device in each columns, with latching position every 10 cm.
- Cable slack detection
- Acoustic warning for foot protection
- Electric upper end switch, ensuring automatic stop at upper position.

IDEAL FOR WHEEL ALIGNMENT

On QUADRA548LA, 552LA, 558LA

- Front recesses for turntables (height 50 mm) with removable covers.
- Rear side slip plate, lockable, covering virtually the whole rear section of the lifting platforms.

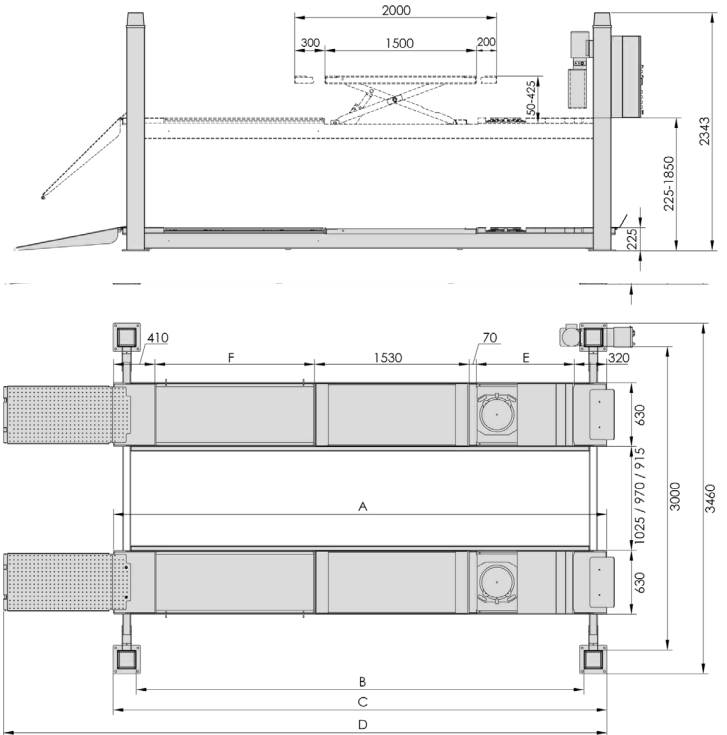

User friendly command unit with push buttons.

Special articulated plastic drag chain for cables and oil tubes routing.

SCHEME	QUADRA552CP	QUADRA548LA	QUADRA552LA	QUADRA558LA
A	5280 mm	4880 mm	5280 mm	5780 mm
B	4838 mm	4438 mm	4838 mm	5338 mm
C	5288 mm	4888 mm	5288 mm	5788 mm
D	6370 mm	5970 mm	6370 mm	6870 mm
E	-	970 mm	970 mm	1170 mm
F	-	1580 mm	1980 mm	2280 mm

SPECIFICATIONS	QUADRA552CP	QUADRA548LA	QUADRA552LA	QUADRA558LA
Lifting capacity, main lift	5 t	5 t	5 t	5 t
Lifting capacity, auxiliary lift	-	4 t	4 t	4 t
Integrated equipment for wheel alignment	no	yes	yes	yes
Net weight	1700 kg	2160 kg	2313 kg	2400 kg
Lifting/lowering time (main lift)	60/55 sec.	60/55 sec.	60/55 sec.	60/55 sec.
Lifting/lowering time (auxiliary lift)	25/20 sec.	25/20 sec.	25/20 sec.	25/20 sec.
Jacking beam 2.6 or 3 t	4207520 + ACH.6228000 or TRAV3P	4207520 + ACH.6228000 or TRAV3P	4207520 + ACH.6228000 or TRAV3P	4207520 + ACH.6228000 or TRAV3P
Nominal hydraulic pressure	180 bars	180 bars	180 bars	180 bars
Power supply	400 V / 3 ph / 50 Hz / 16 A / 2.2 kW			

WHEEL FREE SCISSOR LIFTS



ARGOS30M 3T MID-RAISE WHEEL FREE LIFT

Ref. ARGOS30M

This electro-hydraulic lift features a lifting height of 1000 mm, perfectly adapted to bodywork and works around the wheels.

Anchoring is not required (thus possible). The lift is movable (when unloaded) by the mean of its mobility kit supplied with the lift as standard.

Low profile design (min. height only 105 mm).

The access ramps can be positioned at a horizontal position, providing a lifting platform extension, front and rear. Thus, the lifting platform length can be adjusted from 1420 mm to 2028 mm, making the lift suitable to raise short and long wheelbase vehicles, as well as many commercial vehicles and vans.

- Single phase power supply 230V/ 1 ph / 50 Hz (2,2 kW, 20A)
- No air supply.
- Safety latching devices, electrically operated, with automatic setting without human action.
- Hydraulic oil and 4 rubber lifting pads as standard delivery.
- Lifting/lowering time (loaded) : 30/30 seconds

WHEEL FREE SCISSOR LIFTS

SATELLITE 4369301

DOUBLE SCISSOR LOW PROFILE LIFT 3T

Ref. 4369301

This electro-hydraulic wheel free lift, features a lifting height of 1900 mm, providing optimal access to the vehicle underbody for repair or service works.

Low profile : min. height 105 mm.

The access ramps can be positioned in horizontal position, to extend the lifting platform length. This way, platform length can be adjusted from 1500 mm to 2080 mm to adapt the lift to short and long wheelbase vehicles, as well as many commercial vehicles.

- No air supply.
- The hydraulic safety system is provided by two hydraulic cylinders per platform, with a double-crossed master-slave type hydraulic circuit.
- Photocell is used as light barrier to monitor the correct level of the platforms.
- Hydraulic oil, 4 rubber lifting pads as standard delivery.
- Lifting/lowering time (lift loaded) : 50/60 seconds.



SPECIFICATIONS	ARGOS30M	SATELLITE 4369301
Lifting capacity	3 t	3 t
Mid-raise lift	yes	-
Double scissor lift	-	yes
Movable (not loaded)	yes	-
Lifting/lowering time	30/30 sec.	50/60 sec.
Dimensions (at lowest position) (L x w x h)	2028 x 1995 x 105 mm	2040 x 1990 x 105 mm
Min. height	105 mm	105 mm
Max. lifting height	1000 mm	1900 mm
Platform length	1420-2028 mm	1500-2080 mm
Platform width	460 mm	635 mm
Free space between the platforms	860 mm	720 mm
Power supply	230V / 1 ph / 50Hz / 20 A / 2.2kW	400V / 3 ph / 50Hz / 16 A / 2.2kW
Air supply	no	no

ELECTRO-HYDRAULIC SCISSOR LIFTS



GALAXIE448PLA

4T BIG SCISSOR LIFT, SURFACE MOUNTED

The scissor lift GALAXIE448PLA features a 4t lifting capacity to raise vehicles under their wheels, with integrated hydraulic auxiliary scissor lift for wheel free lifting.

The low profile configuration allows this lift to be installed surface mounted, without any concrete works.

Thanks to its long runways (usable length 4,80 m), this lift is perfectly suitable for wheel alignment applications. Metal covers as standard supply will cover the area reserved for the turntables if their use is not required.

- Lifting capacity : 4000 kg
- Lifting capacity, auxiliary lift : 4000 kg
- Lifting/lowering times : 60/65 sec.
- Max. Height (main platforms) : 1900 mm
- Min. Height : 180 mm
- Platforms width : 660 mm
- Main platform length : 4800 mm
- Auxiliary lift platforms, Max. Height : 450 mm
- Auxiliary lift platform, length : 1445-1950 mm

The surface mounted low profile scissor lift GALAXIE448PLA is particularly suitable for high precision wheel alignment works, This lift does not require any civil engineering works.

SPECIFICATIONS	GALAXIE448PLA
Main lift capacity	4 t
Auxiliary lift, capacity	4 t
Main platforms length	4800 mm
Oil pressure	230 bars
Air pressure	6-8 bars
Power supply	400 V / 3 pH / 50 Hz / 16 A
Motor power	3.5 kW
Net weight	3020 kg
Approval	CE

SPECIFICATIONS	OPTIONS
Front turntables for wheel alignment	option
Jacking beam 2 t (ref.)	Ref. 4207420 + ACH.6228000

RELIABILITY

- All components are tested at the factory. Easy and straightforward installation procedure. Low maintenance requirements..

SAFETY

- Automatically activated mechanical latching device (in compliance with the European regulations currently in force)
- Hydraulic levelling, monitored by a photocell, without any mechanical connection between the two platforms, enabling convenient access under the lifted vehicle.
- User-friendly command unit ergonomically positioned at the ideal height, for a safe and convenient control of the lift.

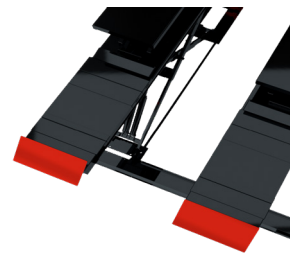

PERFORMANCE

- Lifting platform length 4,80 m, enabling the reception of many light commercial vehicles, long wheelbase vehicles, sport-Utility vehicles, etc. . .
- Integrated wheel free hydraulic scissor lift, that allows all kind of technical lifting operation requiring one or more wheels to be removed.
- Lifting kit high performance with 4 LED lights 24V that can be moved and positioned in different ways to optimize underbody lighting.
- Quick raising, sturdy construction.
- Anti-rust measures : High quality paint with sealer applied at metal joints.
- High precision for wheel alignment.

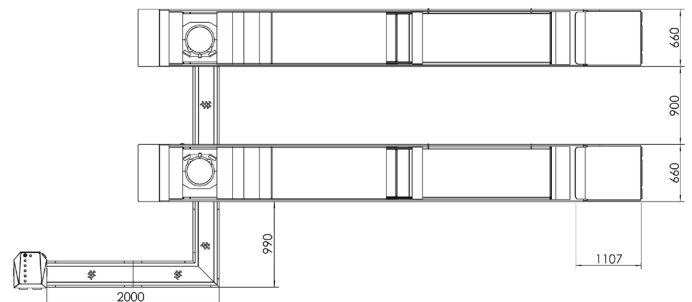
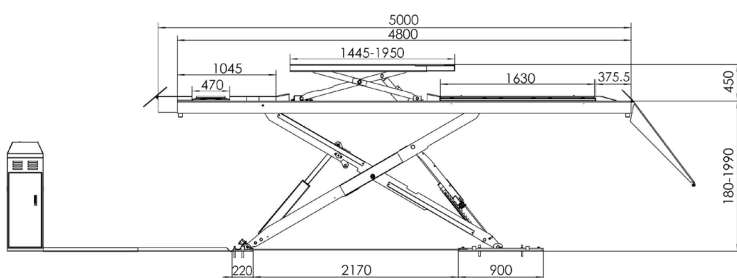

ELECTRO-HYDRAULIC SCISSOR LIFTS



GALAXIE551ELA

5T BIG SCISSOR LIFT, RECESSED

Our scissor lift GALAXIE551ELA features extra-long runways to raise vehicles under their wheels, with integrated auxiliary scissor lift (hydraulic) for wheel free lifting.

The space-saving configuration recessed in a pit provides upper platforms that are flush mounted with regard to the finished ground, allowing reception of vehicles with low ground clearance.

The lift entirely disappears into the pit at lowest position, providing freedom of movements into the workshop.

This lift provides high accuracy for wheel alignment works, including:

- Front recesses for turntables
- Rear side-slip plates, lockable

- Lifting capacity : 5000 kg
- Lifting capacity, auxiliary lift : 3500 kg
- Lifting/lowering times : 70/50 sec.
- Max. Height (main platforms) : 2060 mm
- Min. Height : 360 mm
- Platforms width : 610 mm
- Main platform length : 5100 mm
- Auxiliary lift platforms, Max. Height : 450 mm
- Auxiliary lift platform, length : 1400-2000 mm

The scissor lift GALAXIE551ELA meets the specific requirements for vehicle inspection activities. A wide range of accessories and options, make it suitable for all kinds of duties (wheel alignment, mechanical works).

SPECIFICATIONS	GALAXIE551ELA
Main lift capacity	5 t
Auxiliary lift capacity	3.5 t
Main platforms length	5100 mm
Oil pressure (main lift)	250 bars
Air pressure	6-8 bars
Power supply	400 V / 3 pH / 50 Hz / 16 A
Motor power	3.5 kW
Net weight	2350 kg
Approval	CE

SPECIFICATIONS	OPTIONS
Turntables for wheel alignment	option
Jacking beam 2.6 or 3T	Ref. 4207520 + ACH.6228000 or TRAV3P
Set of 2 long access ramps for on floor installation	Ref. G5R

RELIABILITY

- All components are tested at the factory. Easy and straightforward installation procedure. Low maintenance requirements.

SAFETY

- Automatically activated mechanical latching device, compliant with the European regulations currently in force.
- Hydraulic levelling, monitored by a photocell, without any mechanical connection between the two platforms, enabling convenient access under the lifted vehicle.
- Power unit with user-friendly command unit positioned in an ergonomic way, for a safe and convenient use of the lift.



PERFORMANCE

- Lifting platform length 5,10 m, enabling the reception of most light commercial vehicles, long wheelbase vehicles, sport-Utility vehicles, etc...
- Integrated wheel free hydraulic scissor lifter, totally flush mounted into the main platforms, allowing all kind of technical lifting operation requiring one or more wheels to be removed.
- Lifting kit high performance with 4 LED lights 24V that can be moved and positioned in different ways, to optimize under body lighting.
- Quick raising, sturdy construction.
- Anti-rust measures : High quality paint with sealer applied at metal joints.
- High precision for wheel alignment.

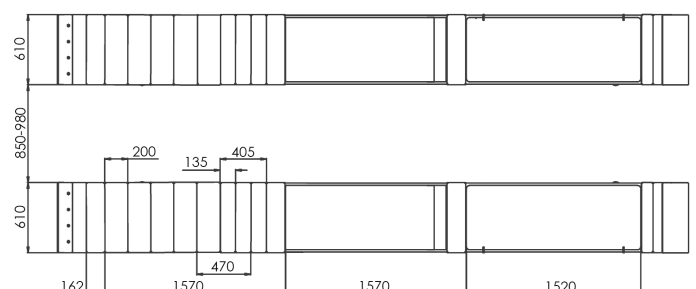
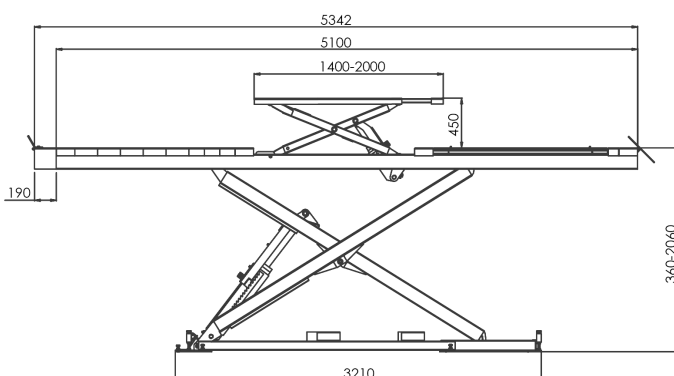

JACKING BEAMS



JACKING BEAMS FOR OUR AUTOMOTIVE LIFTS OR FOR WORKSHOP PITS

Ref. 4207420 - 2.0 t
Ref. 4207520 - 2.6 t

- Logic, ergonomic and simple control system with two handles : one for raising/lowering and one for releasing the latching system.
- Extensible lifting arms with adjustable length (distance between the lifting points 780-1610 mm), to adapt the jacking beam to the wheel track of your vehicles.
- Lifting saddles with height extension pieces +10 , +45 and +90 mm as standard delivery.
- Lifting capacity: 2,0 t or 2,6 t (depending on the model).
- Lifting points: 2
- Air supply: 8 to 12 bar
- Max. Lifting height: 250 mm
- Min. Lifting height: 180 mm

For installation in workshop pit:

- Min. pit width: 780 mm*
- Max. pit width: 1180 mm*



UNIVERSAL AND INDISPENSABLE
SOLUTION FOR JACKING UNDER
AXLE.

JACKING BEAMS

Ref. 4207420 - 2.0 t

Ref. 4207520 - 2.6 t

This jacking beam is designed to raise wheel free under one axle a vehicle placed on an automotive lift or a workshop pit.

Air supplied, with hydro-pneumatic pump, those jacking beams feature a hydraulic lifting cylinder, and a manually released latching device, which goes automatically in locking position when the operator releases the control handle. An hydraulic max. pressure valve prevents any overloading.

Full safety of use is provided by the lowering control, requiring the two hands of the operator to activate the handles. Controls are « hold to run » type.



CORRECT ADAPTATION TO THE PIT WIDTH / TO THE AUTOMOTIVE LIFT

By the mean of a wide choice of possible optional support arms to be fitted at the sides of the jacking beam, the jacking beam can be ideally adapted to workshop pits and those automotive lifts that are equipped with supporting rails for jacking beam.

Equipped with a mechanical locking device, the jacking beam is delivered as standard with lifting accessories which allows for a perfect positioning of the two jacking points under the vehicle :

2 removable rubber lifting saddle (height 10 mm) and 2 height extender (45 and 90 mm)

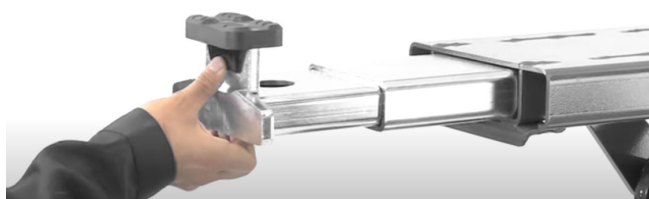

SPECIFICATIONS	4207420	4207520
Lifting capacity	2,0 t	2,6 t
Net weight	110 kg	110 kg
Supply air pressure	8 - 12 bars	8 - 12 bars
Min. lifting points distance	780 mm	780 mm
Max. lifting points distance	1610 mm	1610 mm
Jacking beam min. width (without support arms)	780 mm	780 mm
Jacking beam max. width (without support arms)	1180 mm	1180 mm
Max. lifting height	250 mm	250 mm
Kit 2x support arms for guiding rails	Large choice, adapted to different pits or lifts	

* Please always buy a correct kit of 2x support arms in addition to the jacking beam. Our jacking beams are delivered without support arms.

We help you to determine your correct kit of 2x support arms by sending you a standardized drawing to be filled-in with the dimensions of your pit.

LIFTING TABLE

ELECTRO-HYDRAULIC



4619316

LIFTING TABLE - 1200 KG

Ref. 4619316

This lifting table has been especially designed to easily and safely remove and install heavy batteries from electric vehicles, in conjunction with the use of a 2-post lift such as the Azur42AH.

The table is also suitable for vehicles with conventional thermal motors. The optional set of universal adaptors 4618041 makes it suitable for removing/installing heavy components from the underside of vehicles, such as complete motor/gearbox/axle assemblies, complete axles, complete exhaust systems, etc...

The lifting/lowering movement is motorized, with a remote control connected by wire, and the motion is electro-hydraulic.

The handling of the table throughout the workshop, is easily achieved with the pallet truck type orientable handle, which will raise the table few cm above its supports, and will allow for a very accurate positioning of the table under the load.

Large heavy duty rear wheels, long-lasting.

The lifting platform is:

- extendable, thanks to a sliding extension, lockable in every direction by the mean of low friction ergonomic turning nuts.

The table has been designed for a great physical stability, thus improving safety, even when loaded and fully raised.

Among other safety devices, the table offers a mechanical latching device, automatically operated.



QUALITY

- High quality paint, with perfect finish.
- All technical components, such as hydraulic pack and E-Box.

SAFETY

- Safety latching device, automatically and electrically operated.
- Remote control with an emergency stop button.
- All mechanical components are over-dimensioned, providing the table a great stability.

VERSATILITY

- Full perforated platform (threaded holes), for attaching optional adapters and support pins, in such a way to have them positioned exactly where requested. Such threaded holes will also allow the use of specific supports from carmakers.
- Power supply is standard 230V single phase.
- 2 lifting speeds : first speed for fast approach and slow speed for precision positioning.
- The position of the platform is laterally adjustable (fine-tuning) to avoid the necessity to accurately position the table under the load to be supported/raised.
- Big size handle at the rear of the table, for easy handling.

CHARACTERISTICS	4619316	REMARKS
Lifting capacity	1200 kg	
Min. Height	800 mm	
Max. height	1810 mm	
Lifting platform length	1741 - 2066 mm	
Lifting platform width	800 mm	Platform is laterally adjustable (range: 20 mm)
Lifting platform tilting range	40 mm	
Lifting/lowering time	45 / 40 sec.	
Power supply	220V / 1 ph / 50 Hz	
Motor power	1,5 kW	
Nominal hydraulic pressure	160 bar	With pressure relief valve
Hydraulic oil capacity	4 litres	
Weight	560 kg	

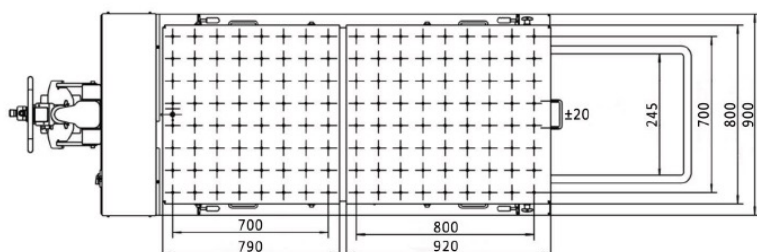
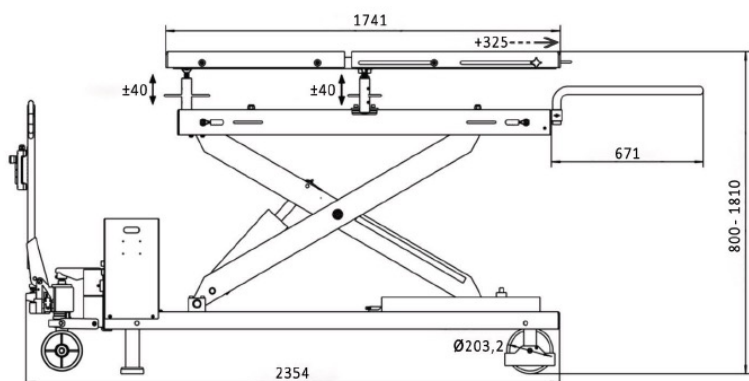

ACCESSORY

Ref. 4618041

Set, 8 universal adaptors, with oblong fixing hole for continuous and accurate position adjustment. The adaptor gets quickly and safely clamped onto the lifting platform, thanks to its thumb screw, to be hand tightened thumb screw.

Comprising :

- 4 adaptors with round pads, adjustable
- 4 adaptors with pin





MULLER AUTOMOTIVE

Site industriel de Chartres
8 Rue Réaumur
Jardin d'Entreprises
28000 CHARTRES
Tel. : +33 2.37.33.34.00
Fax : +33 2.37.33.34.35

www.mullerautomotive.fr

Le contenu (textes et photos) de ce document est non contractuel
et est soumis à des évolutions notamment techniques